



Hirst Court, 20 Gatliff Road
London SW1W

GARTON JONES.COM



Hirst Court, 20 Gatliff Road
London, SW1W

GARTON JONES.COM

8 Gatliff Road
Chelsea
London
SW1W 8DP

Sales +44 (0) 20 7730 5007
gws@gartonjones.com
www.gartonjones.com

£625 Per Week

A spacious one DOUBLE BEDROOM apartment to rent of approx. 678sq.ft (57sq.m) in Hirst Court, part of the popular Grosvenor Waterside development in Chelsea. This FURNISHED apartment has TWO BALCONIES overlooking the dock, an open plan reception room with floor to ceiling windows, a modern kitchen with integrated appliances, en-suite bathroom with separate shower cubicle, plus a guest cloakroom. There is a utility cupboard with storage plus fitted wardrobes, a guest cloakroom and an wood flooring. 24 HOUR CONCIERGE, GYM & SPA. On-site Sainsbury's Local, coffee shop and private kids club. SLOANE SQUARE & VICTORIA station with Gatwick Express are within walking distance.

Available via Garton Jones' on-site office at Grosvenor Waterside (underneath Bramah House).

Please note furniture may differ to that shown in the current photos.

- 678 Sq.ft (57 Sq.m)
- One Double Bedroom
- Open Plan Reception Room
- Integrated Kitchen
- En-Suite Bathroom
- 24 Hour Concierge
- Two Balconies
- Guest Cloakroom
- Smart Leisure Suite with Gym & Spa Facilities
- On-Site Sainsbury's & Close to Sloane Square Transport Links & Amenities



EPC certificate available on request.

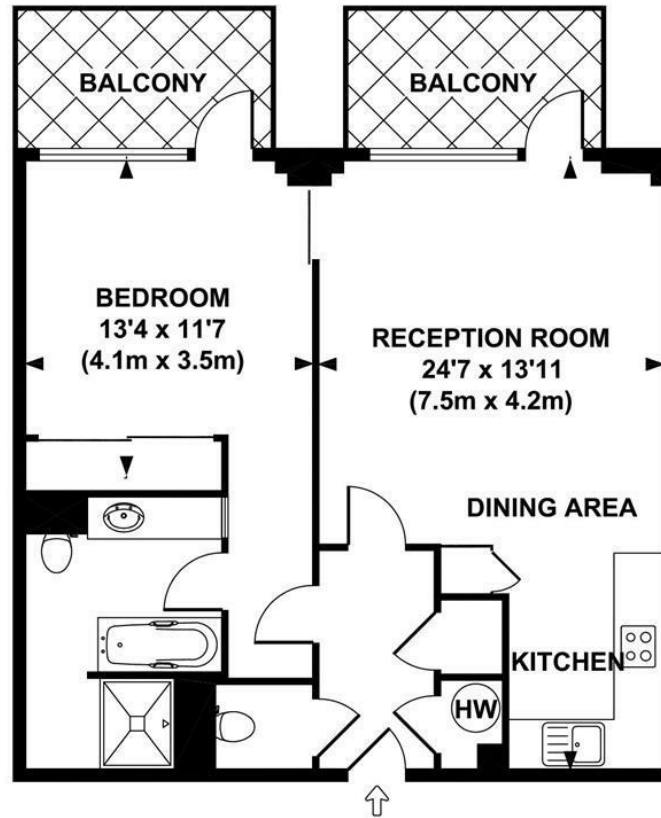

APPROX. GROSS INTERNAL FLOOR AREA 616 SQ FT / 57 SQ M

